



# Defensive Positions

Ambush Phase



# Contents

---

- ▶ Introduction
- ▶ Concealment
- ▶ Pinching the Fat
- ▶ Attacker's Viewpoint
- ▶ Retreat
- ▶ Ammunition
- ▶ Example Layout
- ▶ Defender's Viewpoint
- ▶ Homework
- ▶ Important Notes



# Introduction

Defending Your Home with the Shotgun



# Introduction

---

When you are planning your defense positions, it is kind of hard to get a clear picture of the way a fully functional defensive plan works.

That is why we have included the video with this PDF, to give you a better idea of how it works so that you can adapt it to your own circumstances.



Concealment

Not Cover



# Concealment

---

## Recap:

**Concealment** = Can't be seen by your attacker

**Cover** = Behind something where bullets won't penetrate

**Confession** – yes I realize that in the video I may have mixed up the wording a bit, but you should get the point of what I'm trying to say. Basically, you want to rely on concealment since cover (as I said before) is pretty much non-existent in the average home.

**When** standing/crouching behind the object that you are using as concealment, you don't want to be right up against it. Stand back a little ways so that you have room to manipulate your weapon and relocate quickly.





# Pinching the Fat

Defensive Technique



# Pinching the Fat

---

**The Pinching the Fat technique is a newer defensive idea that keeps less of your body exposed when leaving concealment to shoot at your attackers.**

**The most common form of response is called the Pie Method which basically means that you step all the way out before engaging your target. This is flawed because it exposes too much and requires more to get back to being concealed.**

**By Pinching the Fat, you basically only move your upper torso and lean out long enough to engage and straighten back up behind your concealment.**





# Attacker's Viewpoint

What the Attacker Sees



# Attacker's Viewpoint

**When you expose yourself to aim and shoot at the attacker, you want to show as little as possible.**

**Quickly lean out, aim and shoot, then quickly straighten back up behind your concealment.**



**Minimal Exposure**



# Retreat

When the Attacker Backs Off



# Retreat

---

After the initial engagement, if your attacker is still standing and starts to back out of the home, you want to push forward.

Use your own judgment to decide if you are going to do this. It may be necessary to keep them running, however, keep in mind the laws of the land so that you can make an informed decision when the time comes.

**Warning:** Do not get tunnel vision. Stay aware of your surroundings and be prepared to encounter more than one attacker. You also want to maintain a safe distance so that you have room for error, do not get too close.

If your attacker flees the home, do not follow them outside that door. They may be leading you into another attacker. The door is a fatal funnel and can work both ways. If you can, re-secure the door and exit using another route if you feel the need to ensure that they aren't going to come at you from a different direction. Or you could simply wait for law enforcement to arrive. Just be sure that you do not let your guard down until you can verify that they actually have left and that all threats have been eliminated.



# Ammunition

Be Prepared



# Ammunition

---

As mentioned before in the ambush phase, you want to ensure that you have enough ammo to deal with an attack. Ensure that you store your ammo in an easy to reach locations throughout your home in correlation to your defense plan. The following page shows you an example.



# Example Layout

Ammunition/Weapon Locations

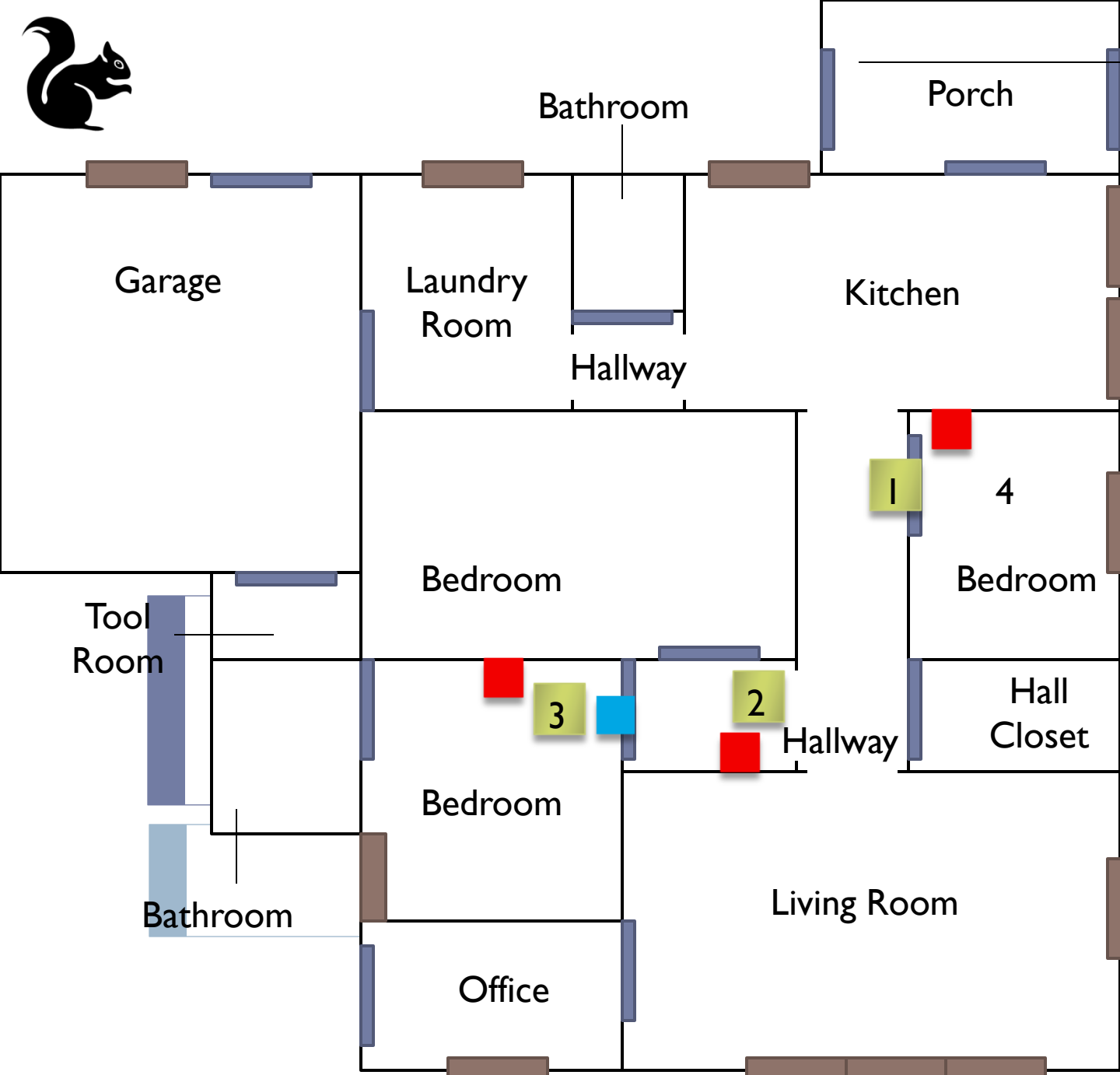

### Sliding Glass Doors

#### Notes:

- The location of your ammo may vary depending on which way the bedroom doors open. Placing them on a high shelf helps prevent little hands from reaching
- By placing an extra weapon above the door of your last defensive position it enables you to reach it easily while it is not as accessible to others (use your own judgment on whether or not to keep it loaded)

#### Key

<u>Defensive Positions</u>	
<u>Ammo</u>	
<u>Weapon</u>	
<u>Door</u>	
<u>Window</u>	



# Defender's Viewpoint

What You will See



## Defender's Viewpoint

---

After the attacker has penetrated your home, you should already be in your first defensive position. Using the Pinch the Fat method, lean out, identify your target, aim and shoot.

Keep moving until you can verify that the threat is no longer there. After you shoot, you need to either fall back to your next position or push forward depending on your circumstances and what the attacker is doing.



# Homework

Prepare



# Homework

---

- ▶ Practice the Pinch the Fat movement (dummy check: unload your weapon first) – work it through with your defensive strategy until you have the method down
- ▶ Double check your ammo and your weapons, make sure that they work well with your home defense strategy
- ▶ Don't forget to practice your plan at least once a month
- ▶ Expand your knowledge – Find a book that addresses a topic of concern for you with home defense and read it
- ▶ If you have a question – Ask! – We are here for you!



# Important Notes

Don't Forget



# Important Notes

---

1. Don't be stupid – use your own judgment when implementing your defensive plan, don't set yourself up for a disaster
2. Always (always!) look for weak spots in your plan – I can't stress that enough
3. Good Luck! Stay safe!

If you have any questions or concerns, please contact us:

[prepare@tackleberrysolutions.com](mailto:prepare@tackleberrysolutions.com)

The content in this course is for purchasers of the Home Defense Plan only. If you would like to share this information, please send them to this link: <https://tackleberrysolutions.com>